

SAFETY POSTER INSTRUCTIONS FOR THE SAFE HANDLING OF YOUR CUTTING TOOL

martor

SECUPRO MERAK

Fully automatic blade retraction for a very high degree of safety

Ergonomic handle for greater efficiency

Blade-change button to release the lever and the blade therein



Safety lock to lock and unlock the lever

Smooth, easy-to-squeeze lever to engage the blade

4-times usable blade for longer durability

USAGE

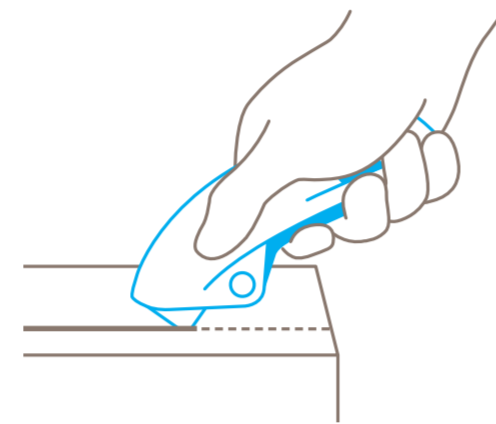

To engage the blade, unlock the cutter and **squeeze the lever**. Now you can cut.

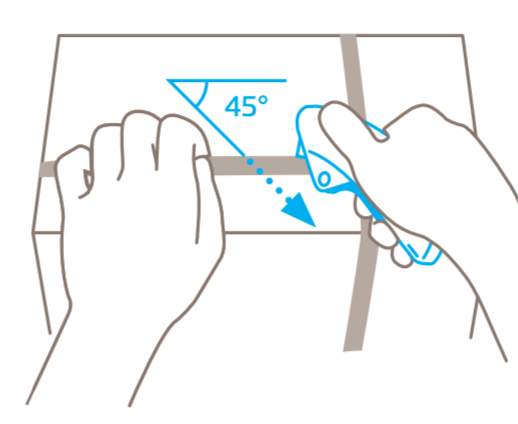

For best results, cut plastic strapping band **diagonally** (at a 45° angle).

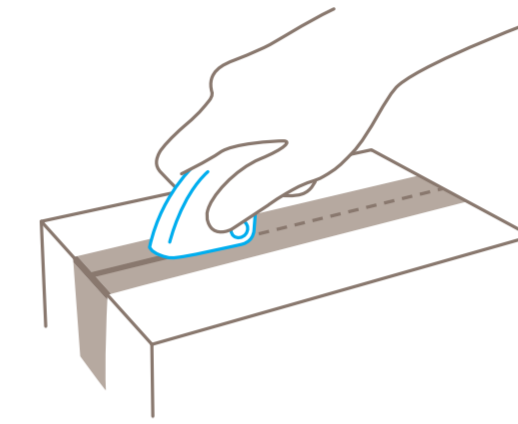

Use the underside of the cutter head as a supporting surface to **work ergonomically** and efficiently.

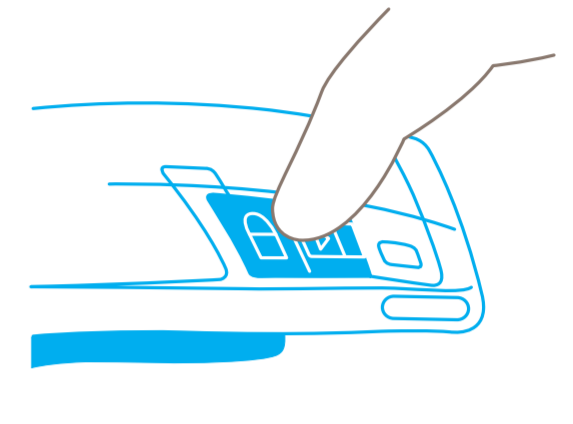

To prevent unintentional blade activation, always **lock the cutter** by pressing downwards on the lock symbol.

BLADE CHANGE

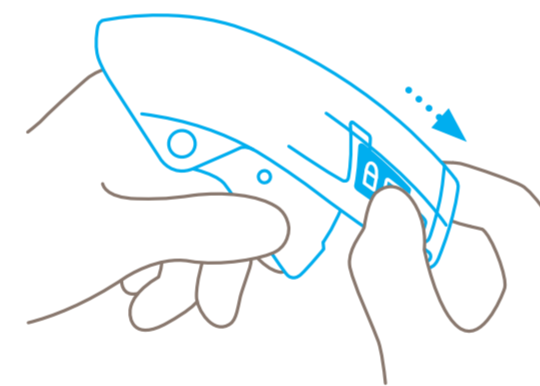

Lock your cutting tool and pull back on the small **black blade-change button**.

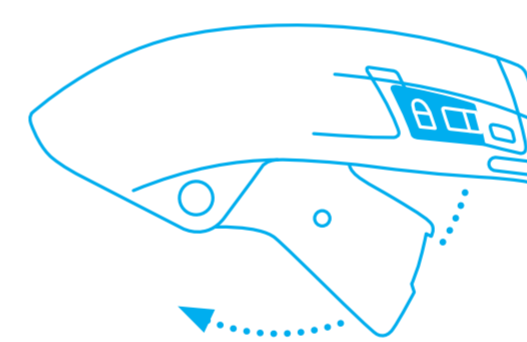

Swing the lever out of the handle and flip open the blade cover.

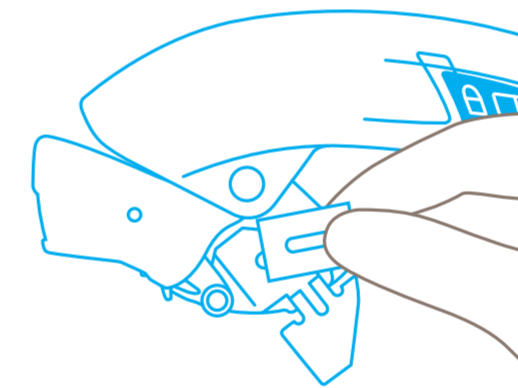

Now you can either **rotate or replace** the blade. Flip the blade cover closed.

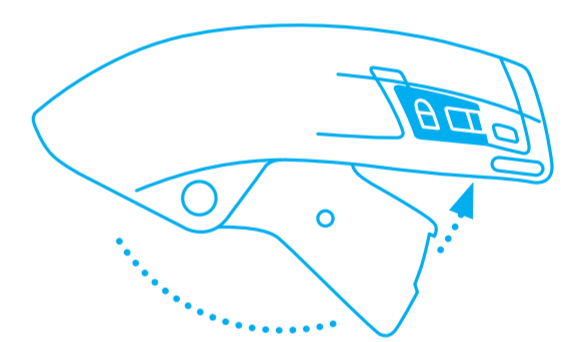

Finally, push the lever back into the handle until you **hear it click into place**.

PROTECTION OF USER

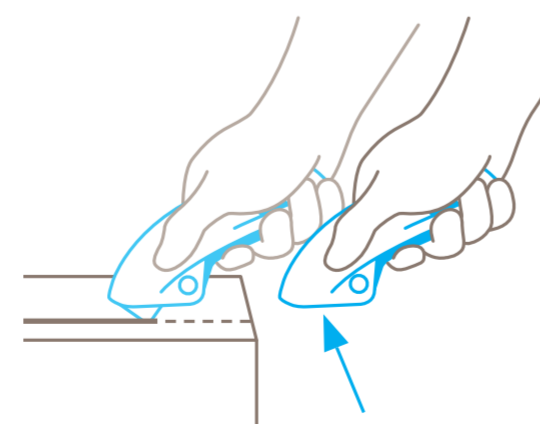

The blade automatically retracts into the handle the moment cutting ceases. Even when the lever is **still being squeezed**.

PROTECTION OF GOODS

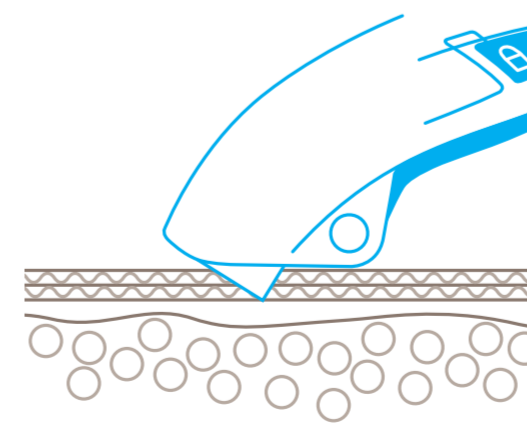

An appropriately **small cutting depth** serves to protect your goods.

DISPOSAL

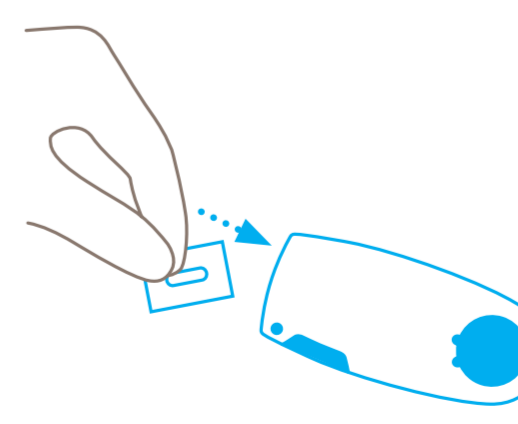

Your SAFEBOX is the best place to store **used blades**.

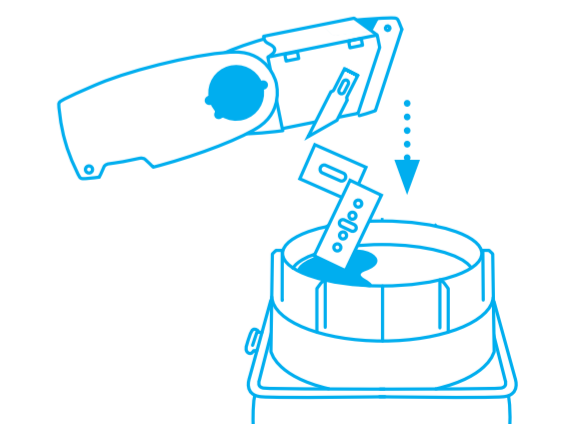

When the SAFEBOX is full, **empty all contents** into your RECYCLING BOX.

Please note: to ensure your product always functions flawlessly, regularly remove any build-up of cutting material.